

NW Corner Section 19-13-27
 Found 1/2" rebar
 shiner top gate post 17.50' NNW
 shiner top fence post 11.80' WNW
 shiner top fence post 17.50' SW
 in line with center of roads south & east

A tract of land in Section 19,
 T-13-N, R-27-W of the 6th P.M.,
 Lincoln County, Nebraska

A tract of land in Section 19, Township 13 North, Range 27 West of the 6th P.M.
 Lincoln County, Nebraska more particularly described as follows:

Beginning at the Southwest Corner of Section 19, Township 13 North, Range 27 West of the 6th P.M., Lincoln County, Nebraska; thence N 01°20'37" E (an assumed bearing) on the west line of said Section 19, a distance of 2606.47 feet to the West Quarter Corner of said Section 19; thence N 01°20'08" E on the west line of said Section 19, a distance of 335.64 feet; thence N 89°08'42" E, a distance of 2173.63 feet; thence S 05°55'45" E, a distance of 329.43 feet; thence S 56°38'03" E, a distance of 145.93 feet; thence S 81°00'09" E, a distance of 469.28 feet; thence S 11°40'44" E, a distance of 808.50 feet; thence S 01°06'06" W, a distance of 1622.74 feet to the south line of said Section 19; thence S 88°29'45" W on said south line, a distance of 443.88 feet to the South Quarter Corner of said Section 19; thence S 88°30'18" W on the south line of said Section 19, a distance of 2551.36 feet to the Point of Beginning; said described tract contains 190.84 acres, more or less, and includes 2.23 acres, more or less, of county roadway.

S 01°20'08" W
 2604.82'
 2805.68'(R)

set at
 31.88' East

N 89°08'42" E
 2173.63'

S 05°55'45" E
 329.43'

S 56°38'03" E
 145.93'

S 81°00'09" E
 469.28'

W1/4 Corner Section 19-13-27
 Found 1 1/2" pipe
 shiner side fence post 29.61' SW
 shiner side fence post 34.80' ENE
 shiner side fence post 32.97' SE
 falls in center of county road

N 01°20'37" E
 2606.47'
 2606.34'(R)

190.84 Acres

S 11°40'44" E
 808.50'

S 01°06'06" W
 1622.74'

S 88°30'18" W
 2551.36'
 2549.25'(R)

S 88°29'45" W
 443.88'

S 88°29'45" W
 2546.42'
 2547.105'(R)

SW Corner Section 19-13-27
 Found 1 1/2" pipe
 shiner side tale post 50.66' NW
 shiner top corner post 48.51' NE
 nail corner tale post 41.35' SE
 shiner side corner post 43.49' SW

S1/4 Corner Section 19-13-27
 Found 5/8" rebar (cap missing)
 shiner top corner post 32.10' SW
 shiner top gate post 14.10' W
 shiner top fence post 40.30' NE
 3/4" gas pipe W/O 32.40' N
 E-W fence is 38' north
 fence W and S is 32' SSW

SE Corner Section 19-13-27
 Found iron wagon skein
 shiner top gate post 24.40' NNE
 shiner top gate post 37.50' N
 shiner top gate post 52.40' NW
 shiner top gate post 38.60' WNW

REFERENCE:

Lincoln County Survey Records

D Sullivan survey in NW 1/4 Sec 30
 dated 2007 - measured and record
 distances are not close to what I
 measured or found of record



0 200 400

- Corner Found
1/2" rebar with OPC
- Corner Set
1/2" x 24" rebar with OPC
- (R) Record Distance
- 2029.99 or (M) Measured Distance
- OPC = Orange Plastic Cap

date: September 25, 2022

A survey was made under my direction as
 shown and is true and correct to the best of
 my knowledge and belief

Bonita M. Edwards
 Bonita M. Edwards LS 454
 Registered Land Surveyor

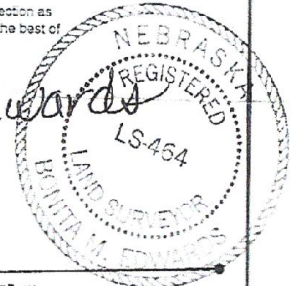

set on Sec. Line
 fence is 38' north